

Fishermans Beach – Darian Road Torquay

FORESHORE UPGRADE WORKS

KEY PROJECT OBJECTIVES

The foreshore car park at the end of Darian Road, Torquay provides for public beach parking and access to the Torquay Sailing Club. The redevelopment of the car parking areas will be undertaken in accordance with the principles and recommendations of the Torquay Foreshore Master Plan and the Great Ocean Road Coast Committee's (GORCC's) Coastal Management Plan (CMP). The key design objectives for redevelopment of the car park include:

- Provision of new BBQ and picnic facilities.
- Create a large flat open grass kick-about area and improve picnic facilities on the coast side away from the road, by relocating the main car park closer to the Esplanade.
- Provision of dedicated disabled parking bays adjacent to the toilets and overlooking Zeally Bay.
- Retention and resurfacing of popular lunchtime and off-peak parking areas with ocean views.
- Closure of the unsealed through road access to Cowrie Road to improve pedestrian safety on the foreshore path and at the toilet block.
- Establishment of vehicle control barriers and indigenous coastal revegetation along the Esplanade.
- Improvement of stormwater drainage incorporating Water Sensitive Urban Design (WSUD) principles.
- Redesign of the unsealed access to the Torquay Sailing Club and retention of existing informal grass trailer parking areas.
- Resurfacing of the steep access to the Torquay Sailing Club and retention of existing informal grass trailer parking areas.

CAR PARK DESIGN

The existing unsealed parking area provides 80-90 spaces. The redeveloped car park design will provide 73 spaces, with 2 disabled parking bays and retention of the existing informal grass parking arrangements for the Torquay Sailing Club. A new parking area with another 8-10 spaces will be formalised closer to the existing toilet block.

Key features of the proposed car park upgrade include:

- Additional flat open grass kick about area and picnic facilities on the coast side away from The Esplanade.
- Asphaltting of the access road and most popular parking spots.
- Improved turn around capacity for longer vehicles.
- Improved safety on the existing Foreshore Trail.
- Provision of integrated stormwater run-off treatment systems.
- The northern end of the car park retains the same proximity and views to the ocean as the existing unsealed car park. These more popular spots will be sealed to reduce ongoing maintenance costs.

COASTAL REVEGETATION

The embankment along the Esplanade will be revegetated with a mix of low coastal indigenous ground layer and grass species. Three small groups of Moonah trees will be carefully located to provide additional shade in the longer term while retaining views. Former car park areas will be re-turfed to enable a level and smooth surface for kick-about and informal games.

Scattered groups of Moonah with low indigenous coastal vegetation to stabilise embankment and retain filtered views

Link new paths to existing crossing points

Removable bollards for event and peak period entry/exit from overflow parking area

Retain and improve drainage to open grass area for public overflow parking and sailing-club trailer storage on peak days

Short term install timber barriers and provide long vehicle pull-over area on the Esplanade

Longer term Surf Coast Shire are planning to widen the Esplanade, improve drainage and establish a long vehicle parking bay. At this time, the need for vehicle barriers will be reviewed.

Close existing through road. Retain unsealed maintenance and path access only.

Install gate and seal access at Cowrie Road to retain Barwon Water and peak period only vehicle access to overflow parking

Longer term Surf Coast Shire are planning a pedestrian refuge to improve safety at the crossing point south of Cowrie Road

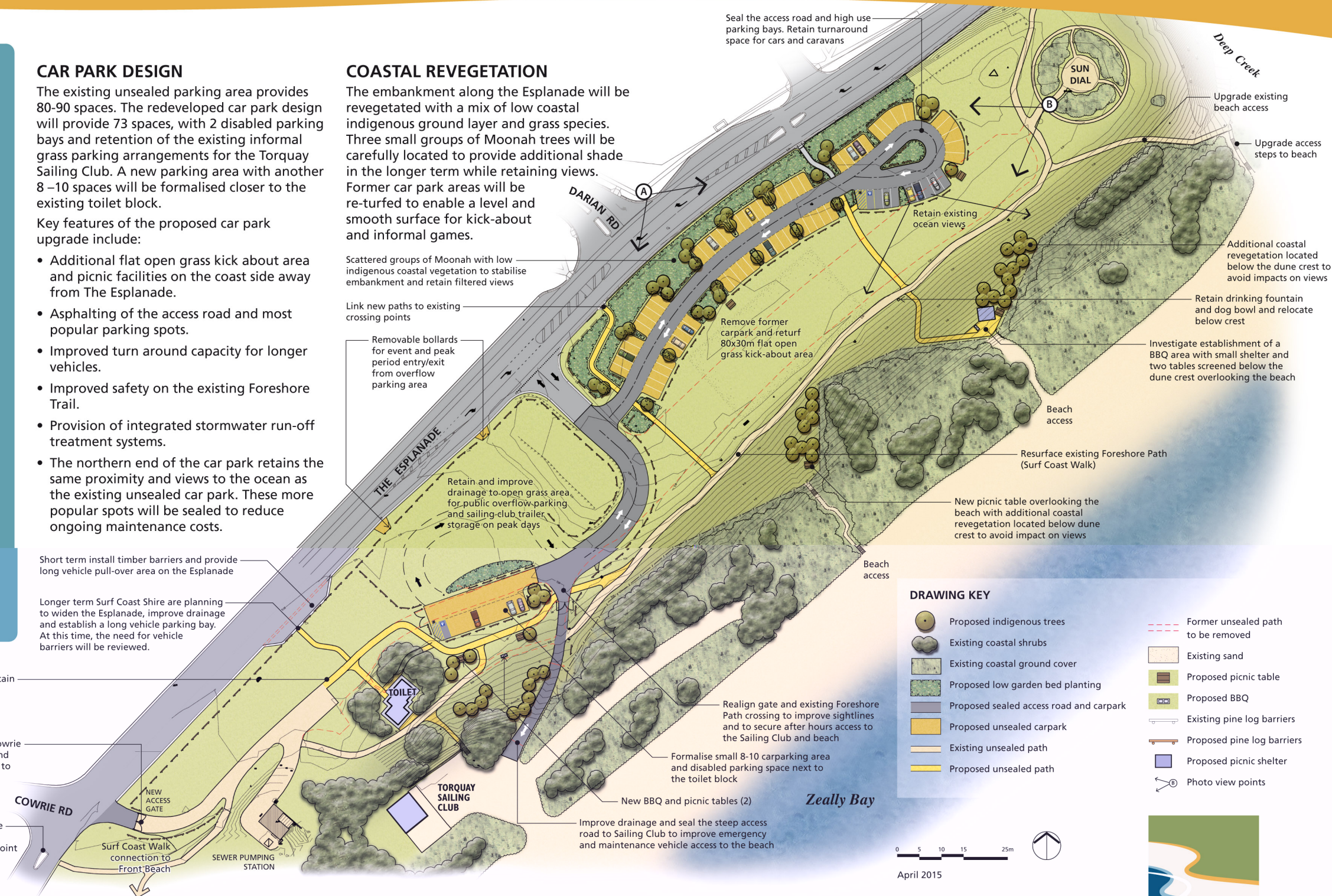

DRAWING KEY

- | | | | |
|--|---|--|------------------------------------|
| | Proposed indigenous trees | | Former unsealed path to be removed |
| | Existing coastal shrubs | | Existing sand |
| | Existing coastal ground cover | | Proposed picnic table |
| | Proposed low garden bed planting | | Proposed BBQ |
| | Proposed sealed access road and carpark | | Existing pine log barriers |
| | Proposed unsealed carpark | | Proposed pine log barriers |
| | Existing unsealed path | | Proposed picnic shelter |
| | Proposed unsealed path | | Photo view points |

0 5 10 15 25m
April 2015