

# ERSKINE Paddock

A local park, a place of sanctuary, a park that plays host to the everyday.

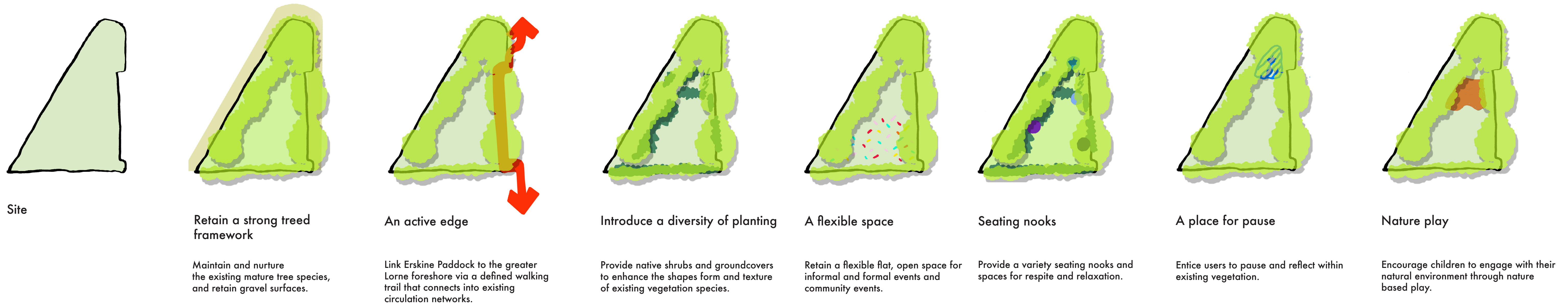

## KEY

- 01 Use the established trees as a framework, enhance both native and indigenous vegetation on site where possible.
- 02 Proposed removal of existing play equipment and old bike path in favour of play features that encourage nature play, which could include a revised trail element that is integrated with other nature play features.
- 03 Retain flat and flexible open space areas within the park. Maintain existing access for events, including temporary displays for events such as the Lorne Sculpture Biennale and overflow parking during major events.
- 04 An active edge: improve links with other circulation networks; improve siting, quality and range of seating and other surfaces, including picnic and bbq facilities, with potential for integration into nature play and exercise activity.
- 05 Retain as a natural and peaceful space.
- 06 Softening of the edge at the boundary with Mantra complex. Suggested additional planting in keeping with the existing landscape character.

